

RIMZ 25 Trimming Procedure



If the ratchet on your revolver looks like this one, found on 625-4 and newer guns, you should not have to trim.



If the ratchet on your revolver looks like this, you may have to trim the inside profile of your RIMZ 25

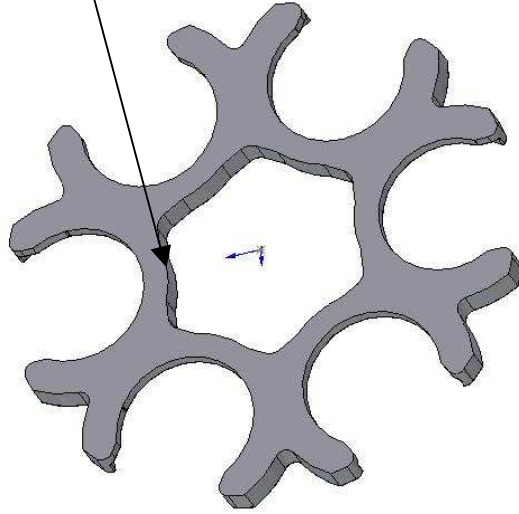

For the S&W 1917, 1937, 25's and some model 625's the clip may need to be trimmed.

Some models of these revolvers were made with the extractors that were fitted to fire 45 Long Colt cartridges with clearance for the cartridge rim. The RIMZ 25 were designed to fit these revolvers. For other models that do not have the relief for the 45 Long Colt rim, the "bump" shown on the illustration must be reduced (flattened) in size.

When looking at the rear of the RIMZ 25 the sharp edge of the flat side may need to be trimmed to allow the clip to fit over the ratchet on the hand extractor on some models of revolvers.

Using an emery board, file, or exacto knife, the 6 edges of the clip should be trimmed at a 45° angle to clear the machining radius on the ratchet on the extractor.

Note:

Certain models of the S&W 625-3 and the 1955 Target (model 25) require the chamfering of this inside edge.

You will notice a large radius on the area where the indexing ratchet and the ejector star intersect.

